

THE SURF SIMS ARE NON MECHANICAL AND DO NOT MOVE. PLAYERS ONLY NEED TO SHIFT WEIGHT SLIGHTLY LEFT/RIGHT

SAFETY FIRST

1. NEVER LEAVE THE SYSTEM UNATTENDED
2. ALWAYS ASSIST AND REMAIN STANDING BY USERS,
3. USING SAFETY RAIL ARE AN OPTION.
4. LEAVE AT LEAST A 6-8 FOOT CLEAR CIRCLE AROUND EACH SYSTEM

APPROACH SURF SIM AT CENTER AND PLACE ONE FOOT ON CENTER OF BOARD FIRST



SURFING SIMULATOR SAFETY INSTRUCTIONS

APPROACH AND STEP ON THE CENTER OF THE BOARD



SHIFT WEIGHT GENTLY LEFT AND RIGHT TO CONTROL GAME

NO QUICK OR FAST MOVEMENTS



NO JUMPING OR LEANING FORWARD / BACKWARDS

Connect Each of the Surf Sim Cables to your PC / Laptop

NOTE; NO ADD EXTRA EXTENSIONS TO EXISTING ONE! DATA LOSS AND LAG!!



How to Check if Two USB Motion Controllers Are Connected on Windows

1 Open the Game Controller Settings window

Click the Windows **Start Menu** (bottom left corner).

Start to type... **USB game-**"SET UP USB will appear in list...

2 Set up USB game controllers Control panel **CLICK ON THIS**

The Game Controllers window will open and display a list of all recognized game controller devices currently connected to your computer.

The name of the device might be Arduino / Motion controller or another name, the main factor is that **TWO** names show up meaning 2 surf sims are connected.

The Game Controllers window will open and display a list of all recognized game controller devices currently connected to your computer.

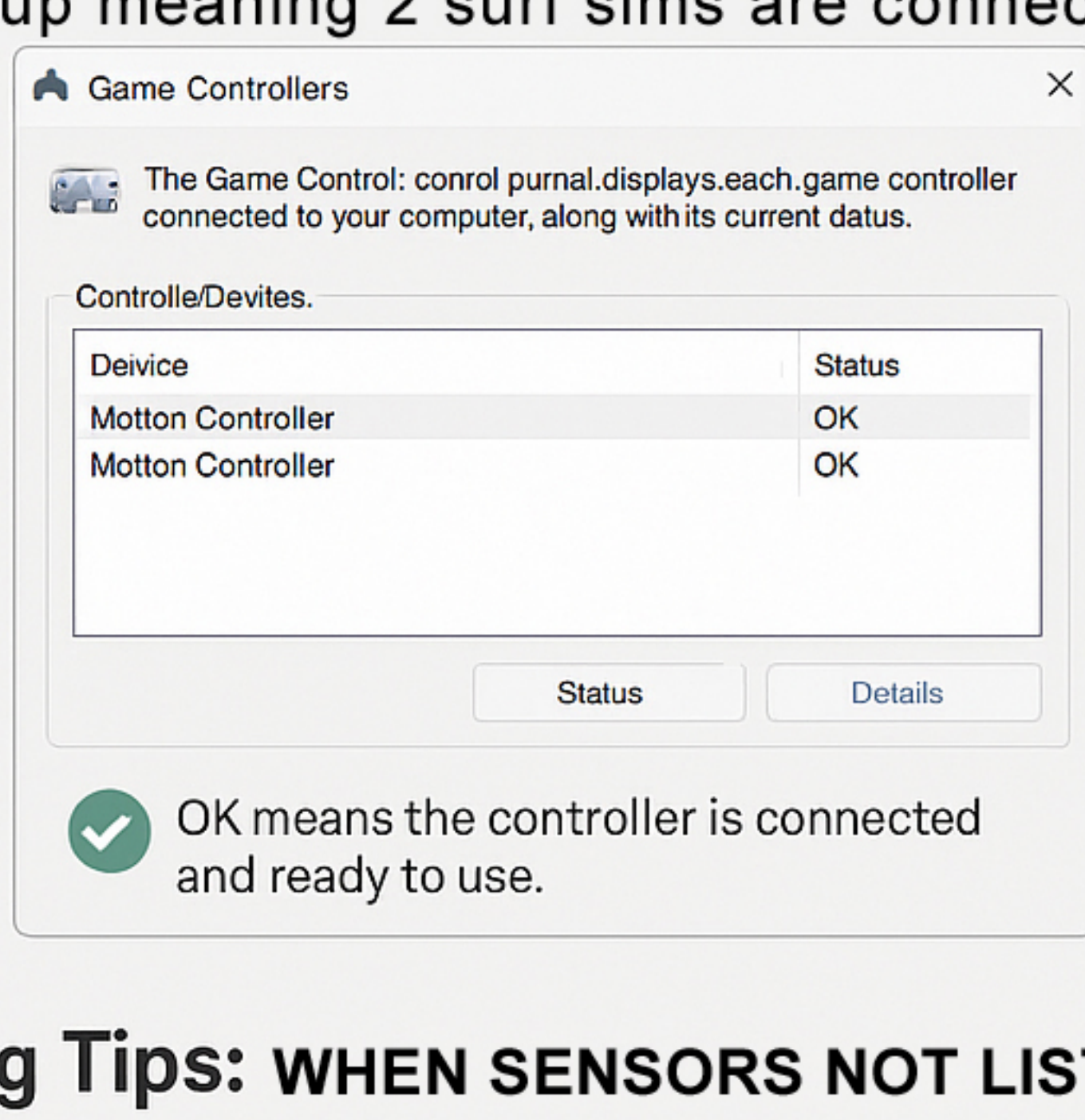

Troubleshooting Tips: WHEN SENSORS NOT LISTED

- Unplug and re-plug each USB connector (-one at a time)
- Try again confirm if recognizing Windows recognition
- Sume sure each controller is plugged into a separate USB port
- Double-check that all cables under the platform are secure and fully inserted and tight fitted for best connections.

- * Unplug and re-plug each USB sensor cable (one at a time until each show up in the list.
- * Make sure with another device that your USB port is actually active
- * Ensure all your connections under the surfboard are also tight.

If for some reason something does not work you can go into our new **EMERGENCY BLACK BOX ACTION**

SIMPLY DISCONNECT THE CABLE FROM THE USB PORT ON THE COMPUTER THAT DOES NOT WORK AND COIL THAT CABLE UP.

GO THRU THE STEPS AGAIN TO RECOGNIZE THE SENSOR AND RESTART THE GAME. NOTE: ANYTIME YOU CHANGE THE SENSORS YOU WILL HAVE TO GO THRU THE USB GAME CONTROLLER SET UP TO SEE IF THE SENSOR IS CONNECTED AND THEN RESTART THE GAME. SENSORS CANNOT BE HOT SWAPPED DURING THE GAME PLAY.

EMERGENCY STEPS WHEN NO RESPONSE FROM SURF SIM OPTION #1



LOCATE THE MAIN CONNECTOR THAT IS CONNECTED TO THE USB EXTENSION AND SIMPLY MOVE IT THE TO BACK UP CONNECTOR AS SHOWN. MAKE SURE YOU GO THRU THE STEPS TO SEE IF IT IS CONNECTED AGAIN USING WINDOWS USB GAME CONTROLLER HELP. RESTART THE GAME AND GO SURF

EMERGENCY BACK UP QUICK OPTION #2 THE BLACK BOX.

SIMPLE QUICK EXECUTION IS TO TAKE ANOTHER USB (MUST BE ACTIVE) EXTENSION AND CONNECT IT TO THE BLACK BOX MALE USB CONNECTION

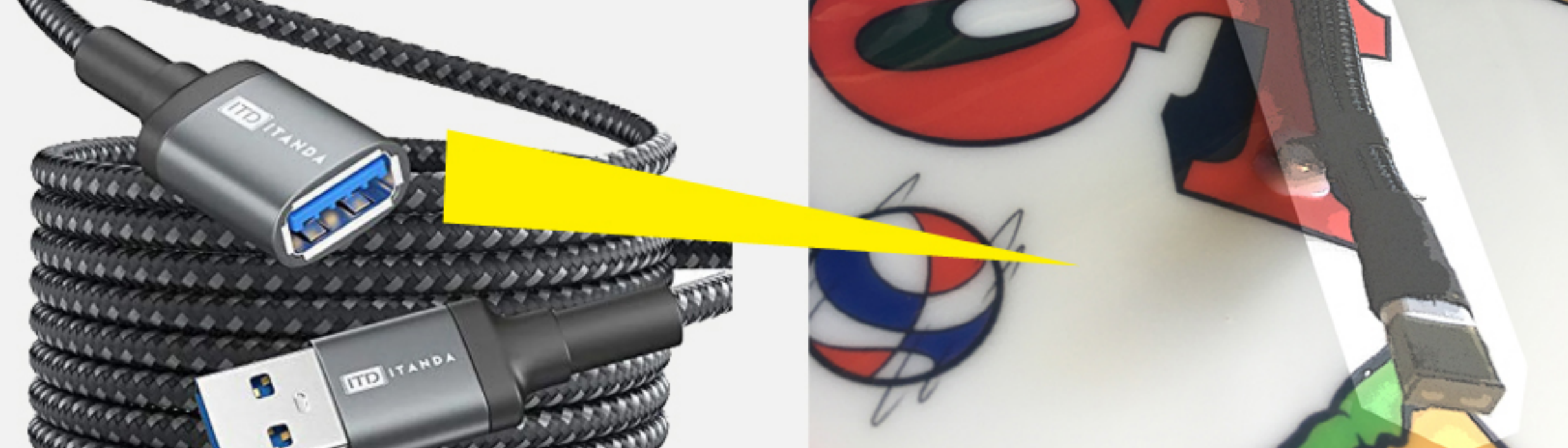

MAKE SURE YOU GO THRU THE STEPS TO SEE IF IT IS CONNECTED AGAIN USING WINDOWS USB GAME CONTROLLER HELP. RESTART THE GAME AND GO SURF

3 Y3 YEAR WARRANTY ON ALL PARTS AND LABOR EXCEPT FOR SURFBOARDS. CUSTOMERS PAY FOR SHIPPING TO AND BACK FOR ANY/ALL REPAIRS